

**INTER  
PUMP**

O MAIOR FABRICANTE MUNDIAL DE BOMBAS A PISTÃO

**BOMBA  
W155**

**EXPLODIDO**

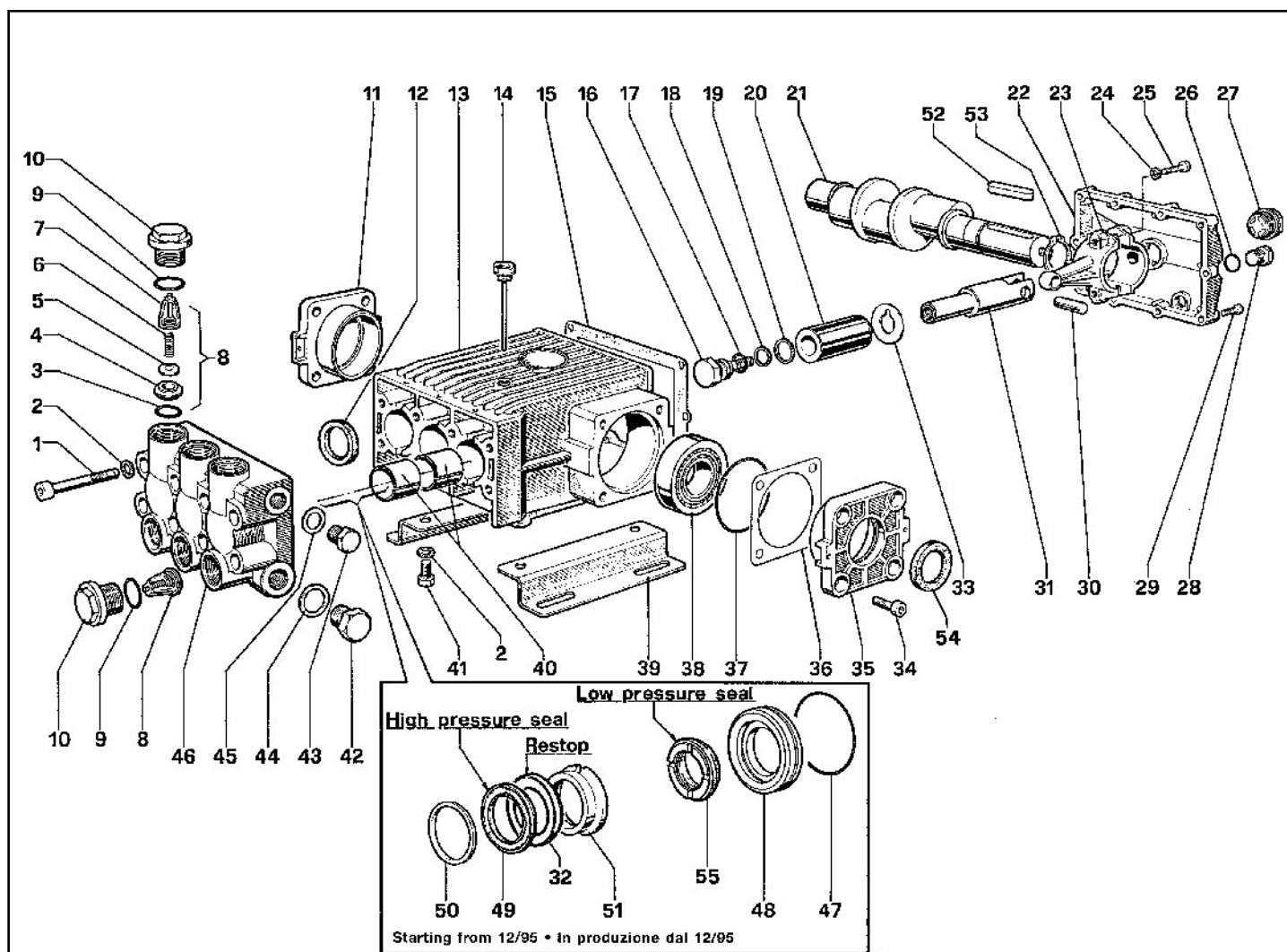

**FIG.01 BOMBA**

Ref.	Cod.Fab.	Cod.CCM	Descricao	Ref.	Cod.Fab.	Cod.CCM	Descricao
01	99-4418-00	3169400	PARAFUSO M12X90 UNI 5931	29	99-1897-00	3165650	PARAFUSO M6x25 UNI 5931 8.8 ZI
02	96-7195-00	3167780	ARRUELA 13X18X1,1 ZINC	30	97-7400-00	3167850	PINO 14X34,5
03	90-4059-00	3169410	ANEL O 32,93X5,53 -B SPEC.	31	77-0500-54	3169500	GUIA PISTAO
04	36-2011-66	3169420	SEDE VALVULA	32	90-2774-00	3169510	ANEL
05	36-2010-76	3169430	VALVULA	33	96-7568-00	3167800	ARRUELA
06	94-7450-00	3169440	MOLA 16X27,5	34	99-3652-00	3168010	PARAFUSO ALLEN M10X20
07	36-2009-51	3169450	GUIA VALVULA	35	76-1500-22	3170360	COBERTURA CARTER
08	36-7065-01	3170340	VALVULA CPL	36	76-2200-78	3167320	ESPAÇADOR
09	90-4065-00	3169460	ANEL 37,69X3,53	37	90-4141-00	3167550	ANEL O
10	98-2420-00	3169470	BUJAO M42X1,5X23	38	91-8474-00	3167630	ROLAMENTO CONICO C/ROLETE
11	76-1501-22	3170370	COBERTURA CARTER	39	76-2000-74	3167290	PEDESTAL DA BOMBA
12	90-1670-00	3168180	RETENTOR 35X52X7 EIXO 135/EMB T88/1	40	90-9172-00	3170470	BUCHA 35X39X30
13	76-0102-01	3170440	CARTER COM BUCHA	41	99-4266-00	3168050	PARAFUSO SEXT M12X25 ZINC
14	98-2270-00	3167890	TAMPA C/HASTE G3/4X102	42	98-2325-00	3167910	BUJAO G1X17 ACC ZINC
15	76-2119-84	3167300	JUNTA CARTER T88	43	98-2265-00	3167880	BUJAO G3/4 X 16 ZINC
16	69-2195-66	3170450	PARAFUSO FIXACAO PISTAO	44	96-7870-00	3167830	ARRUELA 33,5X38X1,5 ALL
17	90-3841-00	3165080	ANEL O 17,13x2,62	45	96-7700-00	3167810	ARRUELA 26,5 X 32 X 1,5 ALL
18	90-5107-00	3167570	ANEL ANTI-EXTRUSAO	46	76-1210-41	3170480	CABECOTE W155
19	96-7555-00	3170460	ARRUELA 22X27X0,5	47	90-3903-00	3169520	ANEL O 60X2,62
20	76-0400-56	3169480	PISTAO CER. 30X22X70 W155/159	48	76-0800-70	3169530	ANEL
21	76-0210-35	3169600	VIRABREQUIM	49	90-2770-00	3169540	ANEL
22	76-1600-22	3170350	COBERTURA CARTER	50	69-1000-51	3169550	ANEL
23	76-0303-01	3169490	BIELA CPL W155	51	69-2167-70	3169560	ANEL INTERMEDIARIO
24	96-7104-00	3167770	ARRUELA 10,5X16X1,0 ZINC	52	91-4978-00	3170530	ALAVANCA
25	99-3720-00	3168030	PARAFUSO	53	90-0695-00	3167420	TRAVA SEGURANCA D35
26	90-3833-00	3161530	ANEL O 13,95x2,62	54	90-1672-00	3167440	RETENTOR 35X52X8 EIXO T33/55/88/177
27	97-5968-00	3162050	BUJAO NIVEL OLEO SX-117/X230	55	90-2776-00	3169570	ANEL
28	98-2100-00	3162140	BUJAO 3/8x13 SX119-X230-TX951				

**KITS**

<b>Kit Nr.</b>	<b>Composição de Itens</b>	<b>Cod.CCM</b>	<b>Descricao</b>
32	54	3168090	KIT RETENTOR
43	3-4-5-6-7	3168120	KIT VALVULA
44	12	3168130	KIT RETENTOR
65	50	3168720	KIT ANEL ENCOSTO
74	16-17-18-19	3168700	KIT PARAFUSO PISTAO
113	32-49-55	3168750	KIT GAXETA
115	32-47-48-49-50-51-55	3168760	KIT GAXETA COMPLETO